

Lanzar[®]

OWNER'S MANUAL

**PLL SYNTHESIZER STEREO RADIO WITH
COMPACT DISC PLAYER DIGITAL**

VBD 500

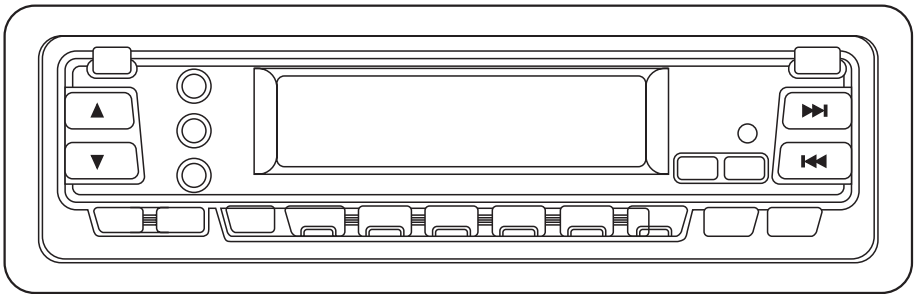

INSTALLATION

Notes:

- Choose the mounting location where the unit will not interfere with the normal driving function of the driver.
- Before finally installing the unit, connect the wiring temporarily and make sure it is all connected up properly and the unit and the system work properly.
- Use only the parts included with the unit to ensure proper installation. The use of unauthorized parts can cause malfunctions.
- Consult with your nearest dealer if installation requires the drilling of holes or other modifications of the vehicle.
- Install the unit where it does not get in the driver’s way and cannot injure the passenger if there is a sudden stop, like an emergency stop.
- If installation angle exceeds 30° from horizontal, the unit might not give its optimum performance.

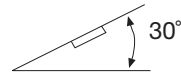

- Avoid installing the unit where it would be subject to high temperature, such as from direct sunlight, or from hot air, from the heater, or where it would be subject to dust, dirt or excessive vibration.

DIN FRONT/REAR-MOUNT

This unit can be properly installed either from “Front” (conventional DIN Front-mount) or “Rear” (DIN Rear-mount installation, utilizing threaded screw holes at the sides of the unit chassis). For details, refer to the following illustrated installation methods.

DIN FRONT-MOUNT (Method A)

Installation the unit

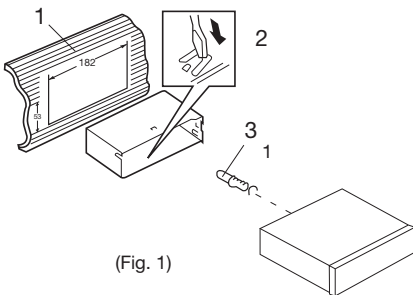

1. Dashboard
2. Holder
After inserting the holder into the dashboard, select the appropriate tab according to the thickness of the dashboard material and bend them inwards to secure the holder in place.
3. Screw

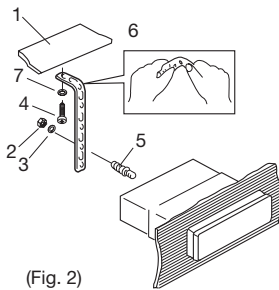

(Fig. 2)

1. Dashboard
2. Nut (5mm)
3. Spring washer
4. Screw (5 x 25mm)
5. Screw
6. Strap
Be sure to use the strap to secure the back of the unit in place. The strap can be bent by hand to the desired angle.
7. Plain washer

Removing the unit

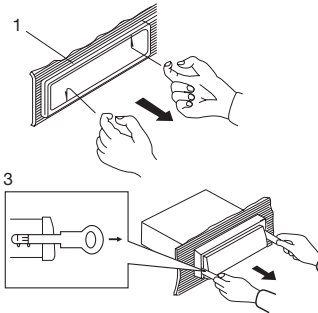

1. Frame
2. Insert fingers into the groove in the front of frame and pull out to remove the frame. (When re-attaching the frame, point the side with a groove downwards and attach it.)
3. Lever
Insert the levers supplied with the unit into the grooves at both sides of the unit as shown in figure until they click. Pulling the levers makes it possible to remove the unit from the dashboard.

DIN REAR-MOUNT (Method B)

Installation using the screw holes on the sides of the unit.

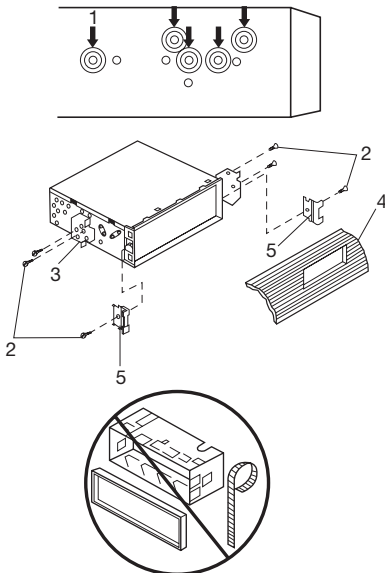

Fastening the unit to the factory radio mounting bracket.

1. Select a position where the screw holes of the bracket and the screw holes of the main unit become aligned (are fitted), and tighten the screws at 2 places on each side.
Use either truss screws (5 x 6mm) or flush surface screws (4 x 6mm), depending on the shape of the screw holes in the bracket.
2. Screw
3. Factory radio mounting bracket
4. Dashboard or Console
5. Hook (Remove this part)

Note: The mounting box, outer trim ring, and half-sleeve are not used for method B installation.

USING THE DETACHABLE FRONT PANEL

To Detach the Front Panel

1. Press the open button (open), then the front panel will be folded down.

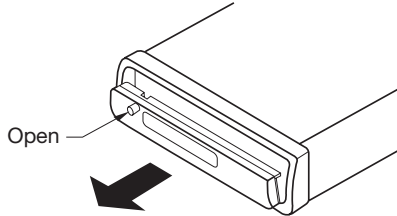

2. Remove the front panel by pulling its middle-hand outward.

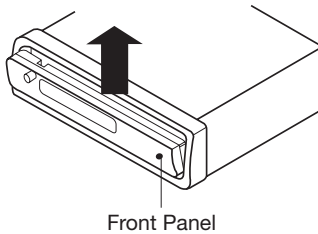

3. For safekeeping, store the front panel in the supplied protective case immediately after being removed.

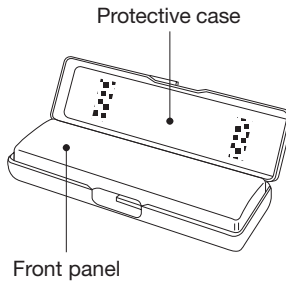

4. Push the front metal plate into the main body. A 'click' sound should be heard.

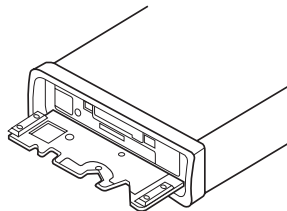

To Reinstall the Front Panel

1. Push the front panel into the main body. A 'click' sound should be heard.

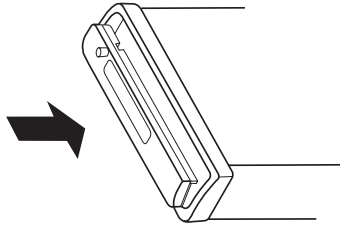

2. Note that if the front panel fails to lock in position properly, press control button may not function and LCD display may be missing some segments. Pushing the open button and then reinstall the front panel again.

Precautions when Handling

1. Do not drop the front panel.
2. Do not put pressure on the display or control buttons when detaching or reinstalling the front panel.
3. Do not touch the contacts on the front panel or on the main unit body. It may result in poor electrical contact.
4. If any dirt or foreign substances adhered on the contacts, they can be removed with a clean and dry cloth.
5. Do not expose the front panel to high temperatures or direct sunlight in anywhere.
6. Keep away any volatile agents (e.g. benzene, thinner, or insecticides) from touching the surface of the front panel.
7. Do not attempt to disassemble the front panel.

WIRING CONNECTION

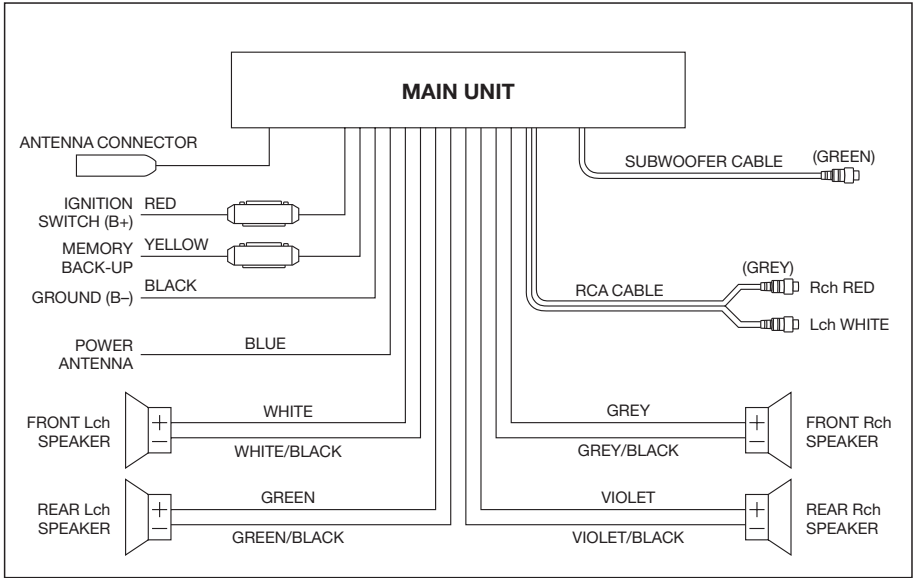

OPERATION

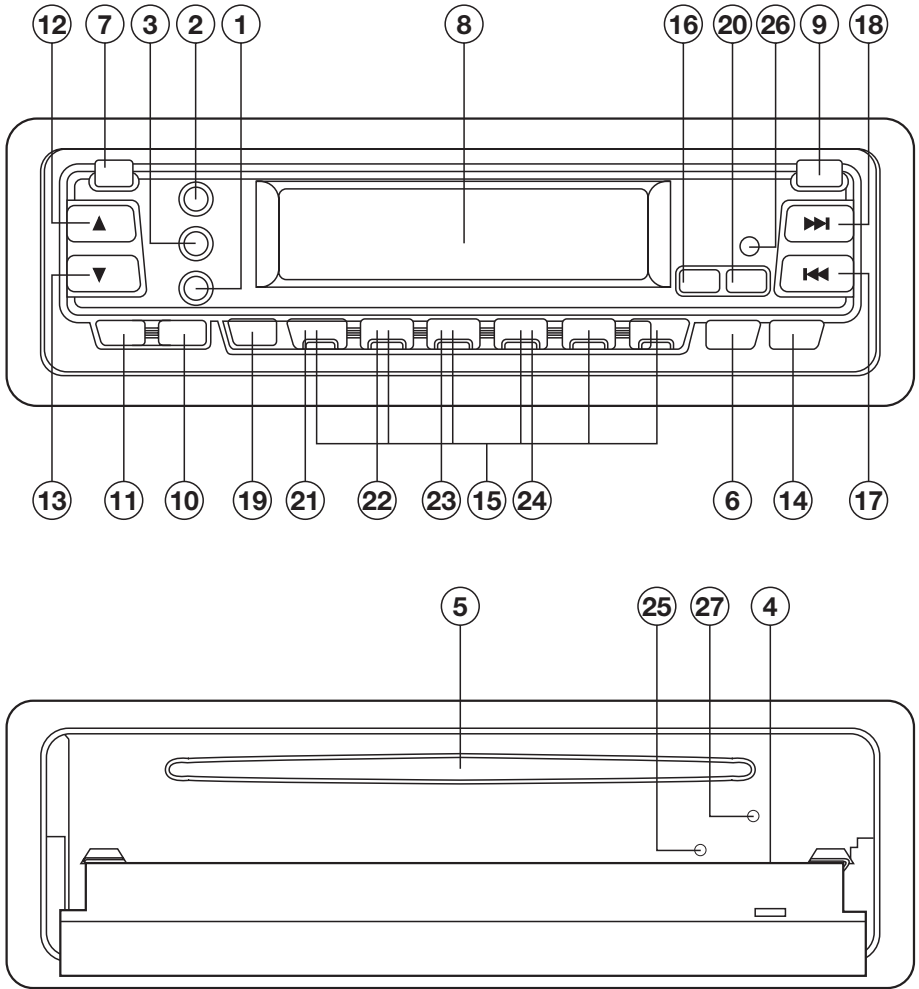

GENERAL OPERATION

- **ON/OFF**
Switch on the unit by pressing any button [except **OPEN** button (7) and **EJECT** button (4)]. When system is on, press **PWR** button (9) to turn off the unit.
- **FACEPLATE RELEASE**
Press **OPEN** button (7) to detach the removable faceplate.

- **SOUND ADJUSTMENT**

Press **SEL** button (11) to select the desired adjustment mode. The adjustment mode will change in the following order:

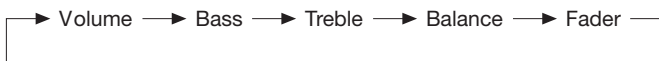

By pressing **VOLUME ▲** button (12) or **VOLUME ▼** button (13), it is possible to adjust the desired sound quality.

- **LOUDNESS**

Press **LOU/BND** button (14) for several seconds to reinforce the bass output and display will show “**LOUD**”. Press it for several seconds again to release this function.

- **SET THE CLOCK**

Holding down the **DSP** button (16) until the clock is shown on the LCD display and flashed. Then press the **MAN/SEK▶▶▶** button (18) to change hours or **MAN/SEK◀◀◀** button (17) to change minutes.

- **SELECT MODE**

Press **MOD** button (6) to choose desired listening mode. (e.g. radio mode to CD mode)

- **SUBWOOFER**

Press **MOD/SW** button (6) for several seconds to toggle subwoofer output. When subwoofer on, display will show “**SW**”. Press it again for several seconds to release this mode.

- **MUTE**

Press **MUT** button (10) to silence the receiver. Press it again to resume listening.

- **LIQUID CRYSTAL DISPLAY**

Exhibit current frequency and activated functions on the display (8).

- **EQUALIZATION**

Press **EQ** button (20) to turn on equalization function and to select desired audio mode. There are five kinds of mode as below:

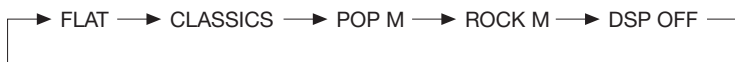

- **REMOTE SENSOR**

Point the remote control handset to the remote sensor **IR-sensor** (26). Press the function keys on the handset to control the system.

- **FLASHING LED**

If the front panel does not install in the unit, the **LED** (25) will be flashing.

- **RESET**

Reset button (27) is placed on the front panel and must be activated with either a ball point pen or thin metal object. The reset button is to be activated for the following reasons:

- Initial installation of the unit when all wiring is completed.
- All the function buttons do not operate.
- Error symbol on the display.

Note: If press **RESET** button (27), the unit can't work yet, please use a cotton swab soaked in isopropyl alcohol to clean the socket on the back of the front panel.

RADIO OPERATION

- **BAND SELECTION**

At tuner mode, press **LOU/BND** button (14) shortly to select the desired band. The reception band will change in the following order:



- **STATION SELECTION**

Press **MAN/SEK** **◀◀** button (17) or **MAN/SEK** **▶▶** button (18) shortly to activate automatic seek function. Press for several seconds until **“MANUAL”** appeared on the display, the manual tuning mode is selected. If both buttons have not pressed for several seconds, they will retune to seek tuning mode and **“AUTO”** appeared on the display.

- **LOCAL/DISTANCE**

Press **LOC** button (2) to select between local and distant stations. Local setting for reception of strong station, and a distant setting for reception of weaker stations. This function is effect during AUTO SEEK operation.

- **AUTOMATICALLY MEMORY STORING & PROGRAM SCANNING**

- Automatic Memory Storing

Press **AMS** button (19) the radio searches from the current frequency and checks the signal strength until one cycle search is finished. And then 6 strongest stations are stored into the corresponding preset number button.

- Program Scanning

Press **AMS** button (19) shortly to scan preset station. When the field strength level is more than the threshold level of stop level, the radio is holding at that preset number for several seconds with releasing mute, then searches again.

- **STATION STORING**

Press any one of the preset buttons (15) (M1 to M6) to select a station which had been stored in the memory. Press this button for several seconds, current station is stored into the number button.

- **MONO/STEREO**

Press **MON** button (3) to select mono or stereo mode. You can sometimes improve reception of distant stations by selection mono operation.

- **SCAN**

Press **SCAN** button (1) to set the function to scan mode, which scanning to higher frequency station with receivable signal and keep on each station for several seconds.

CD OPERATION

- **SELECT TRACKS**

Press **MAN/SEK** button ◀◀ (17) or ▶▶ (18) to move to the previous track or the following track. Track number shows on display.

Hold **MAN/SEK** button ◀◀ (17) or ▶▶ (18) to fast reverse or fast forward. CD play starts from when you release the button.

- **STOP PLAYING**

Press **PAU** button (21) to pause CD player. Press it again to resume play.

- **REPEAT THE SAME TRACK**

Press **RPT** button (23) to continuously repeat the same track.

Press again to stop repeat.

- **PREVIEW ALL TRACKS**

Press **SCN** button (22) to play first several seconds of each track on the current disc. Press again to stop intro and listen to track.

- **PLAY ALL TRACKS IN RANDOM**

Press **SHF** button (24) to play all tracks on CD in random order. Press again to cancel the function.

- **EJECT**

Press **EJECT** button (4) to stop CD play and eject the disc from the slot.

NOTE ON CD-R/CD-RW DISCS

- On this unit, in addition to an audio CD, you can play your original CD-R or CD-RW that contain audio titles.
- However, depending on the conditions of the recording equipment or the CD-R/CD-RW disc itself, some CD-Rs or CD-RWs cannot be played on this unit.
- DO NOT stick paper or tape, etc. onto the label side or the recording side of any CD-R/CD-RW, as it may cause a malfunction.

REMOTE CONTROL HANDSET

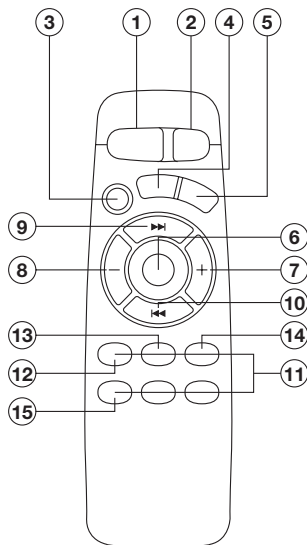

CONTROL & FUNCTION KEYS

- | | |
|----------------|--|
| 1. POWER | = Power ON/OFF Button |
| 2. MOD | = Mode Button |
| 3. S (SEL) | = Select Button |
| 4. DSP | = Display Button |
| 5. BND | = Band Select Button |
| 6. AMS | = Automatically Memory Storing & Program Scanning Button |
| 7. VOL + | = Volume Up Button |
| 8. VOL - | = Volume Down Button |
| 9. TUN/SEK ►► | = Tune/Seek Up Button |
| 10. TUN/SEK ◄◄ | = Tune/Seek Down Button |
| 11. M1 - M6 | = Preset Buttons |
| 12. PAU | = Pause Button |
| 13. SCN | = Scanning Button |
| 14. RPT | = Repeat Button |
| 15. SHF | = Shuffle Button |

SPECIFICATION

GENERAL

Power Supply Requirements : DC 12 Volts, Negative Ground
Chassis Dimensions : 178 (W) x 163 (D) x 50 (H)
Tone Controls
- Bass (at 100 Hz) : +10 dB / -10 dB
- Treble (at 10 KHz) : +10 dB / -10 dB
Maximum Output Power : 50W x 4 (ch)
Current Drain : 15 Ampere

CD PLAYER

Signal to Noise Ratio : More than 60 dB
Channel Separation : More than 60 dB
Frequency Response : 20 Hz - 20 KHz

RADIO

FM

Frequency Coverage : 87.5 to 107.9 MHz
IF : 10.7 MHz
Sensitivity (S/N = 30 dB) : 3 μ V
Stereo Separation : > 30 dB

AM

Frequency Coverage : 530 to 1710 KHz
IF : 450 KHz
Sensitivity (S/N = 20 dB) : 32 dBu

TROUBLE SHOOTING

Before going through the check list, check wiring connection. If any of the problems persist after check list has been made, consult your nearest service dealer.

Symptom	Cause	Solution
No power.	The car ignition is not on.	If the power supply is properly connected to the car accessory terminal, switch the ignition key to "ACC".
	The fuse is blown.	Replace the fuse.
Disc cannot be loaded or ejected.	Presence of CD disc inside the player.	Remove the disc in the player, then put a new one.
	Inserting the disc in reverse direction.	Insert the compact disc with the label facing upward.
	Compact disc is extremely dirty or defective disc.	Clean the disc or try to play a new one.
	Temperature inside the car is too high.	Cool off or until the ambient temperature return to normal.
	Condensation.	Leave the player off for an hour or so, then try again.
No sound.	Volume is in minimum.	Adjust volume to a desired level.
	Wiring is not properly connected.	Check wiring connection.
The operation keys do not work.	The built-in microcomputer is not operating properly due to noise.	Press the RESET button. Front panel is not properly fixed into its place.
Sound skips.	The installation angle is more than 30 degrees.	Adjust the installation angle to less than 30 degrees.
	The disc is extremely dirty or defective disc.	Clean the compact disc. Then try to play a new one.
The radio does not work. The radio station automatic selection does not work.	The antenna cable is not connected.	Insert the antenna cable firmly.
	The signals are too weak.	Select a station manually.

www.lanzar.com